



K100 Brushless a condensatore

Brushless with Capacitor
Sin escobillas con condensador

KR100 A spazzole con AVR

Brush with AVR
Con escobillas y AVR

IT | Caratteristiche tecniche

K100
Tensione standard 50Hz: 230V, 240V 60Hz: 110/220V, 120/240V Altri valori a richiesta
Classe d'isolamento H
Protezione IP 23
T.H.D. ≤ 6%
Precisione tensione ± 5%, - 10% (cosφ = 1)
Capacità di spunto (Icc > 3In)
Optional Quadro elettrico, Carica batterie

KR100
Tensione standard 50Hz: range 110÷120/220÷240V 60Hz: range 110÷120/220÷240V Altri valori a richiesta
Classe d'isolamento H
Protezione IP 23
T.H.D. ≤ 6%
Precisione tensione ± 2% (indipendentemente dal cosφ)
Capacità di spunto (Icc > 3In)
Optional Quadro elettrico, Carica batterie
Regolatore automatico di tensione AVR 520

EN | Technical characteristics

K100
Standard voltage 50Hz: 230V, 240V 60Hz: 110/220V, 120/240V Other voltages on request
Insulation class H
Protection IP 23
T.H.D. ≤ 6%
Voltage accuracy ± 5%, - 10% (cosφ = 1)
Starting capacity (Icc > 3In)
Optional Electrical panel, Battery charger

KR100
Standard voltage 50Hz: range 110÷120/220÷240V 60Hz: range 110÷120/220÷240V Other voltages on request
Insulation class H
Protection IP 23
T.H.D. ≤ 6%
Voltage accuracy ± 2% (regardless of cosφ)
Starting capacity (Icc > 3In)
Optional Electrical panel, Battery charger
Automatic Voltage Regulator AVR 520

ES | Características técnicas

K100
Voltaje estándar 50Hz: 230V, 240V 60Hz: 110/220V, 120/240V Otros valores a pedido
Clase de aislamiento H
Protección IP 23
T.H.D. ≤ 6%
Precisión del voltaje ± 5%, - 10% (cosφ = 1)
Capacidad de arranque (Icc > 3In)
Optional Cuadro eléctrico, Carga baterías

KR100
Voltaje estándar 50Hz: gama 110÷120/220÷240V 60Hz: gama 110÷120/220÷240V Otros valores a pedido
Clase de aislamiento H
Protección IP 23
T.H.D. ≤ 6%
Precisión del voltaje ± 2% (independientemente de cosφ)
Capacidad de arranque (Icc > 3In)
Optional Cuadro eléctrico, Carga baterías
Regulador automático de voltaje AVR 520

Modello Model Modelo	Potenza Output Power Potencia			Potenza assorbita Driving Power Potencia absorbida		Potenza Output Power Potencia			Potenza assorbita Driving Power Potencia absorbida		Peso Weight Peso		
	cosφ 1	cosφ 0,8		4/4 - cosφ 1		cosφ 1	cosφ 0,8		4/4 - cosφ 1		cone	B34	SAE
	S1	S2	S1	[kW]	η %	S1	S2	S1	[kW]	η %	[kg]	[kg]	[kg]
	[kVA]	[kVA]	[kVA]			[kVA]	[kVA]	[kVA]					

	50Hz - 3000rpm					60Hz - 3600rpm							
	2,2	2,5	---	3,1	70,0	2,7	3,0	---	3,8	71,0			
K100 B	2,2	2,5	---	3,1	70,0	2,7	3,0	---	3,8	71,0	16,0	---	---
K100 C	2,7	3,0	---	3,8	71,0	3,5	3,8	---	4,9	72,0	17,0	---	---
K100 D	3,5	3,8	---	4,9	72,0	4,5	4,8	---	6,2	73,0	17,5	---	---
K100 E	4,2	4,5	---	5,8	73,0	5,5	6,0	---	7,4	74,0	20,0	---	---
K100 F	5,0	5,5	---	6,7	75,0	6,0	6,5	---	7,9	76,0	21,5	---	---
K100 FX	5,5	6,0	---	7,3	75,5	6,5	7,0	---	8,5	76,5	23,5	---	---
K100 G	6,0	6,5	---	7,9	76,0	7,2	7,7	---	9,4	77,0	25,0	---	---
KR100 D	3,5	3,8	2,8	4,9	71,0	4,2	4,5	3,3	5,8	72,0	17,5	---	---
KR100 E	4,2	4,5	3,3	5,8	72,0	5,0	5,5	4,0	6,8	73,5	20,0	---	---
KR100 FX	5,0	5,5	4,0	6,6	76,0	6,0	6,5	4,8	7,8	77,0	23,0	---	---
KR100 G	6,0	6,5	4,8	7,8	77,0	7,2	7,7	5,7	9,2	78,0	25,0	---	---

CONE

Overall Dimensions
Dimensiones

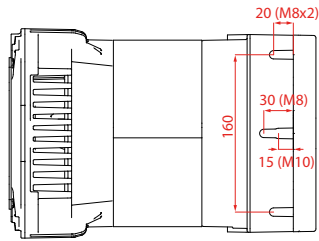
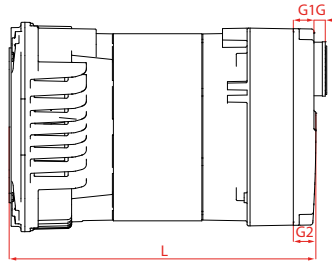
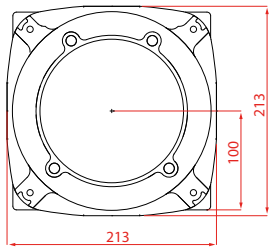

J609a
C 19

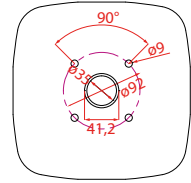
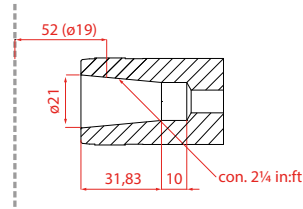

J609b
C 22
C 25,4

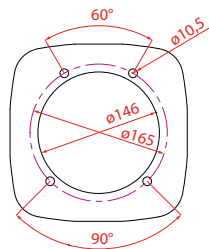
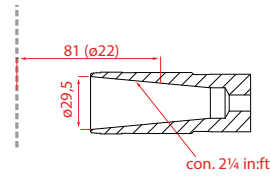

C 23

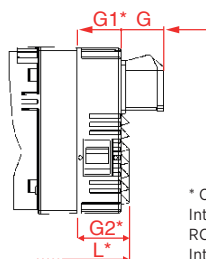
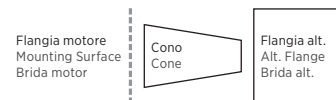
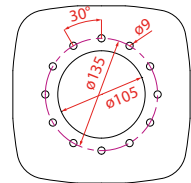
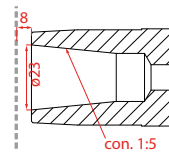

* Optional:
Int. differenziale
RCCB
Int. diferencial

	L	G1	G2			
	[mm]					
K100 B	299	*337	21	*53	25	*63
K100 C	299	*337	21	*53	25	*63
K-KR100 D	299	*337	21	*53	25	*63
K-KR100 E	314	*352	21	*53	25	*63
K100 F	324	*362	21	*53	25	*63
K-KR100 FX	339	*377	21	*53	25	*63
K-KR100 G	354	*392	21	*53	25	*63

Prese Sockets Tomas	G
	[mm]
Schuko	13
CEE 16A	55
CEE 32A	67
NEMA	1

Dati tecnici non impegnativi: NSM si riserva il diritto di apportare modifiche senza l'obbligo di darne preventiva comunicazione.

Technical data not binding: NSM reserves the right to modify the contents without prior notice.

Datos técnicos sin compromiso: NSM se reserva el derecho de hacer cambios sin previo aviso.