

M132

Brushless a condensatore

Brushless with Capacitor
Sin escobillas con condensador

MR132

A spazzole con AVR

Brush with AVR
Con escobillas y AVR

IT | Caratteristiche tecniche

M132

Tensione standard
50Hz: 115/230V, 120/240V
60Hz: 110/220V, 120/240V
Altri valori a richiesta

Classe d'isolamento H

Protezione IP 23

T.H.D. ≤ 5%

Precisione tensione +5%, -8% (cosφ = 1)

Capacità di spunto (Icc ≥ 3In)

MR132

Tensione standard
50Hz: range 220÷240V
60Hz: range 220÷240V
Altri valori a richiesta

Classe d'isolamento H

Protezione IP 23

T.H.D. ≤ 6%

Precisione tensione ± 1,5% (indipendentemente dal cosφ)

Capacità di spunto (Icc ≥ 3In)

Regolatore automatico di tensione AVR 860

- Provvisto di protezioni per Sottovelocità, Massima tensione, Massima corrente di eccitazione, Sovraccarico prolungato (max kVA)
- Possibilità di regolare la tensione a distanza

EN | Technical characteristics

M132

Standard voltage
50Hz: 115/230V, 120/240V
60Hz: 110/220V, 120/240V
Other voltages on request

Insulation class H

Protection IP 23

T.H.D. ≤ 5%

Voltage accuracy +5%, -8% (cosφ = 1)

Starting capacity (Icc ≥ 3In)

MR132

Standard voltage
50Hz: range 220÷240V
60Hz: range 220÷240V
Other voltages on request

Insulation class H

Protection IP 23

T.H.D. ≤ 6%

Voltage accuracy ± 1,5% (regardless of cosφ)

Starting capacity (Icc ≥ 3In)

Automatic Voltage Regulator AVR 860

- Supplied with protections for Underspeed, Maximum voltage, Maximum excitation current, Prolonged overload (max kVA)
- Remotely adjustable voltage regulator

ES | Características técnicas

M132

Voltaje estándar
50Hz: 115/230V, 120/240V
60Hz: 110/220V, 120/240V
Otros valores a pedido

Clase de aislamiento H

Protección IP 23

T.H.D. ≤ 5%

Precisión del voltaje +5%, -8% (cosφ = 1)

Capacidad de arranque (Icc ≥ 3In)

MR132

Voltaje estándar
50Hz: gama 220÷240V
60Hz: gama 220÷240V
Otros valores a pedido

Clase de aislamiento H

Protección IP 23

T.H.D. ≤ 6%

Precisión del voltaje ± 1,5% (independientemente de cosφ)

Capacidad de arranque (Icc ≥ 3In)

Regulador automático de voltaje AVR 860

- Equipado con protecciones para Sub-velocidad, Máxima tensión eléctrica, Máxima corriente de excitación, Sobrecarga prolongada (max kVA)
- Posibilidad de regulación de la tensión a distancia

Modello Model Modelo	Potenza Output Power Potencia		Potenza assorbita Driving Power Potencia absorbida		Potenza Output Power Potencia		Potenza assorbita Driving Power Potencia absorbida		Peso Weight Peso		
	cosφ 1 [kVA]	cosφ 0,8 [kVA]	4/4 - cosφ 1 [kW] η %		cosφ 1 [kVA]	cosφ 0,8 [kVA]	4/4 - cosφ 1 [kW] η %		cone [kg]	B34 [kg]	SAE [kg]
	50Hz - 1500rpm				60Hz - 1800rpm						
M132 XSA	4,5	---	5,8	77,0	5,5	---	7,1	78,0	46,0	48,0	54,0
M132 XSB	6,5	---	8,1	80,0	8,0	---	9,9	81,0	52,0	54,0	60,0
M132 SA	8,5	---	10,5	81,0	10,0	---	12,2	82,0	62,0	64,0	70,0
M132 SB	10,0	---	12,2	82,0	12,5	---	15,1	83,0	71,0	73,0	79,0
M132 MA	12,5	---	14,9	84,0	15,0	---	17,6	85,0	88,0	90,0	96,0
M132 LB	16,0	---	18,9	84,5	20,0	---	23,4	85,5	118,0	120,0	126,0
MR132 SA	8,0	6,5	9,9	81,0	10,0	8,0	12,2	82,0	64,0	66,0	72,0
MR132 SB	10,0	8,0	12,2	82,0	13,0	10,0	15,7	83,0	73,0	75,0	81,0
MR132 MA	13,0	10,0	15,5	84,0	16,0	13,0	18,8	85,0	90,0	92,0	98,0
MR132 LB	16,0	13,0	18,9	84,5	20,0	16,0	23,4	85,5	120,0	122,0	128,0

CONE

Overall Dimensions
Dimensiones

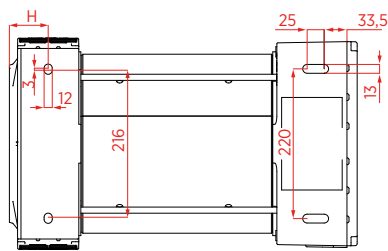
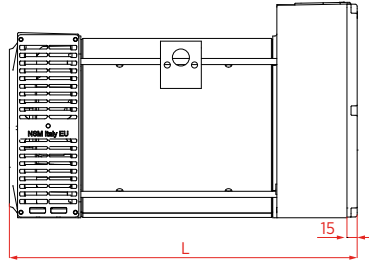
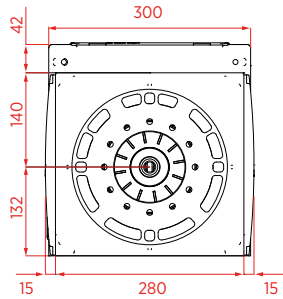

J609b

C 25,4
C 35

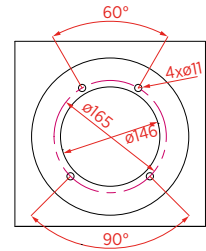
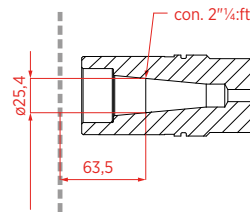

C 30

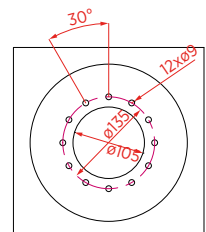
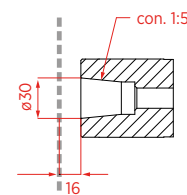

Flangia motore
Mounting Surface
Brida motor

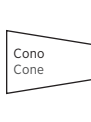

Flangia Alt.
Alt. Flange
Brida Alt.

B34

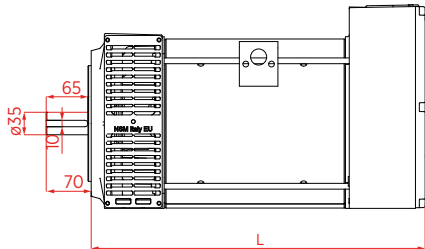
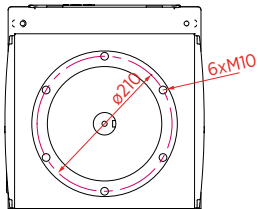

SAE

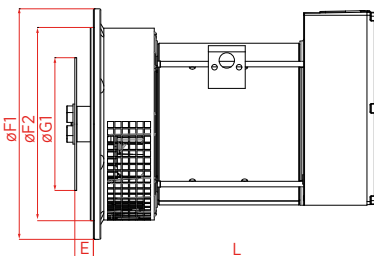
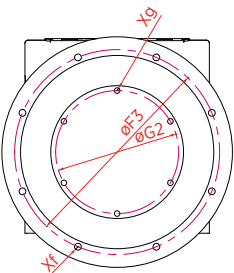

SAE	Flangia Flange Brida			
	ØF1	ØF2	ØF3	Xf
	[mm]			
5	375	314,33	333,40	Ø11 (8)
4	405	361,95	381,00	Ø11 (12)
3	450	409,58	428,63	Ø11 (12)

SAE	Giunto Joint Junta			
	ØG1	ØG2	E	Xg
	[mm]			
6,5	215,90	200,02	30,2	Ø9 (6)
7,5	241,30	222,25	30,2	Ø9 (8)
8	263,52	244,48	62,0	Ø11 (6)
10	314,32	295,28	53,8	Ø11 (8)
11,5	352,42	333,37	39,6	Ø11 (8)

	cone		B34		SAE 5-4		SAE 3	
	L	H	L	H	L	H	L	H
	[mm]							
M132 XS-	411	57	419,5	65,5	410	---	400,5	---
M-MR132 S-	461	57	469,5	65,5	460	---	450,5	---
M-MR132 MA	511	57	519,5	65,5	510	---	500,5	---
M-MR132 LB	606	57	614,5	65,5	605	---	595,5	---

Dati tecnici non impegnativi: NSM si riserva il diritto di apportare modifiche senza l'obbligo di darne preventiva comunicazione.

Technical data not binding: NSM reserves the right to modify the contents without prior notice.

Datos técnicos sin compromiso: NSM se reserva el derecho de hacer cambios sin previo aviso.